

DATA SHEET

**DVT 3.140**

# ROTARY VANE PRESSURE/VACUUM PUMPS

oil-free

air-cooled

---

**MAKE IT BECKER.**



figure DVT 3.80

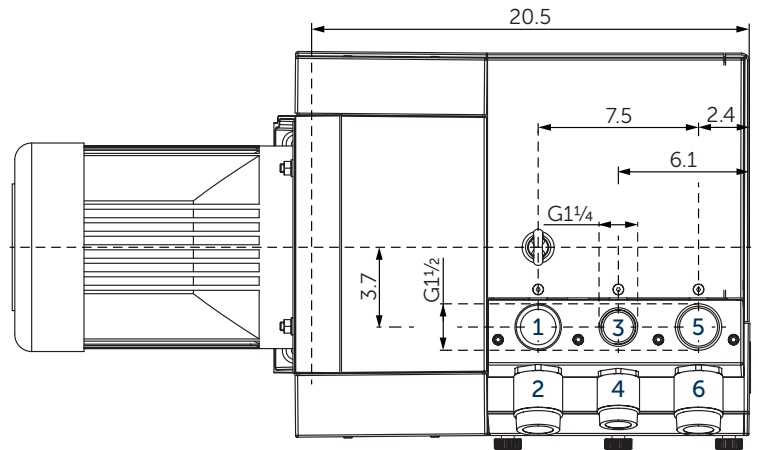
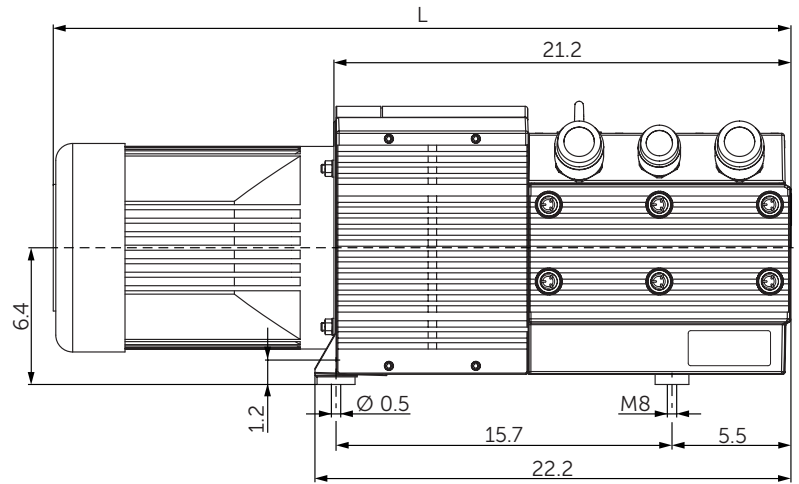
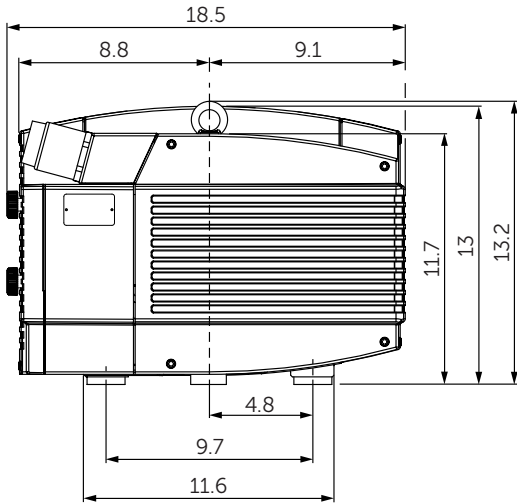

- 1 Pressure connection (G1½)
- 2 Pressure regulating valve
- 3 Option: second suction (G1¼)
- 4 Option: vacuum regulating valve for second suction
- 5 Vacuum connection (G1½)
- 6 Vacuum regulating valve
- The motor illustration may vary.
- Dimensions in inch

Capacity		Pressure		Vacuum		Motor		Emission sound pressure level <sup>1)</sup>		Weight without motor
CFM		PSIG		in. HgV		hp		dB(A)		lbs
50 Hz	60 Hz	50 Hz	60 Hz	50 Hz	60 Hz	50 Hz	60 Hz	50 Hz	60 Hz	
80	94	7.25	7.25	15	15	10.0	10.0/12.0	77-78	78-79	172
80	94	8.7	8.7	18	18	10.10	10.0/12.0	77-78	78-79	172

<sup>1)</sup> DIN EN ISO 3744 (KpA = 3 dB(A)), interval of 39.4inch, at medium load, both connection sides piped

3~ Motors <sup>1)</sup>												L	
#	50 Hz				60 Hz				Version	Weight lbs	inch		
	hp	V	rpm	A	hp	V	rpm	A					
05	10.1	Δ400	IE3	1445	16.0	12.1	Δ460	IE3	1735	15.5	IP55 • ISO F • bimetal	121.3	37.5
							Δ400						
06						12.1	YY230/Y460	IE3	1763	33.6/16.8	UL(E235514) • CSA CC329B IP55 • ISO F • bimetal	149.9	37.1
							YY208			1760			
07	10.1	Δ200/Y350	IE3	1450	31.8/18.3	12.1	Δ220/Y380-400	IE3	1760	31.5/18.2-17.3	IP55 • ISO F • bimetal	121.3	37.5
							Δ200/Y350			1745			
08						12.1	Δ400/Y690	IE3	1760	19.2/11.1	IP55 • ISO F • bimetal	121.3	37.5
05						10.0	YY230/Y460	IE3	1800	25.2/12.6	UL • CSA • NEMA • ISO F	180.0	37.0
							YY208			1745			

• Current consumption and rotation speed may vary. Tolerance in each case -1.5/+2%

Air rates • power consumptions • temperatures											
pressure	PSIG			vacuum							
				50 Hz				60 Hz			
				0 in. HgV	12 in. HgV	15 in. HgV	18 in. HgV	0 in. HgV	12 in. HgV	15 in. HgV	18 in. HgV
+0.4		Suction air rate	CFM	74.5	42.4	34.1	25.3	88.3	49.4	39.4	30.0
		Blast air rate	CFM	82.4	60.6	48.9	48.3	96.5	69.5	61.8	54.2
		Power consumption	hp	6.80	7.21	7.28	7.28	8.98	8.84	8.57	8.57
		Temperature compressed air	°F	113.0	131.0	132.8	132.8	125.6	136.4	138.2	140.0
+0.5		Suction air rate	CFM	74.2	40.6	32.4	24.1	87.7	48.9	39.1	29.4
		Blast air rate	CFM	81.2	59.4	53.6	47.1	95.9	68.9	61.2	53.6
		Power consumption	hp	6.94	7.254	7.41	7.41	9.18	8.98	8.91	8.84
		Temperature compressed air	°F	116.6	131.0	132.8	132.8	127.4	138.2	140.0	141.8
+0.6		Suction air rate	CFM	74.2	38.3	30.0	22.4	87.1	48.9	38.8	29.4
		Blast air rate	CFM	81.2	58.3	52.4	45.9	95.4	68.3	60.6	53.0
		Power consumption	hp	7.14	7.55	7.55	7.62	9.32	9.18	9.25	9.32
		Temperature compressed air	°F	120.2	132.8	132.8	134.6	129.2	138.2	140.0	141.8

Reference data (atmosphere): 0 PSIG (in. HgV), 68°F  
 Tolerance: ±5%  
 Air temperature: 41°F ... 135°F

## **+** VARIANTS AND ACCESSORIES

- With first and second suction
- With external suction filter<sup>1)</sup>
- Sound proof box SH 13<sup>1)</sup>



Example for an external suction filter



Sound proof box SH 13

<sup>1)</sup> See separate data sheet  
▪ Possible combinations on request



**MAKE IT BECKER.**

